

NEW AMENITIES AT SADDLEBROOKE RANCH

Amenities at SaddleBrooke Ranch just keep getting better! Ed's Dogs is now open and provides an additional casual dining option with gourmet hotdogs and mouthwatering hamburgers. Two new tennis courts are now available, bringing the community total to six courts and four Bocce Ball Courts are now available along with a ramada that includes storage for supplies as well as bocce and tennis equipment. The Community Garden is now open and features 110 individual 4ft x 8ft boxes that can be leased by homeowners on an annual basis. The community garden also includes material/storage boxes, a storage shed, and ramada.

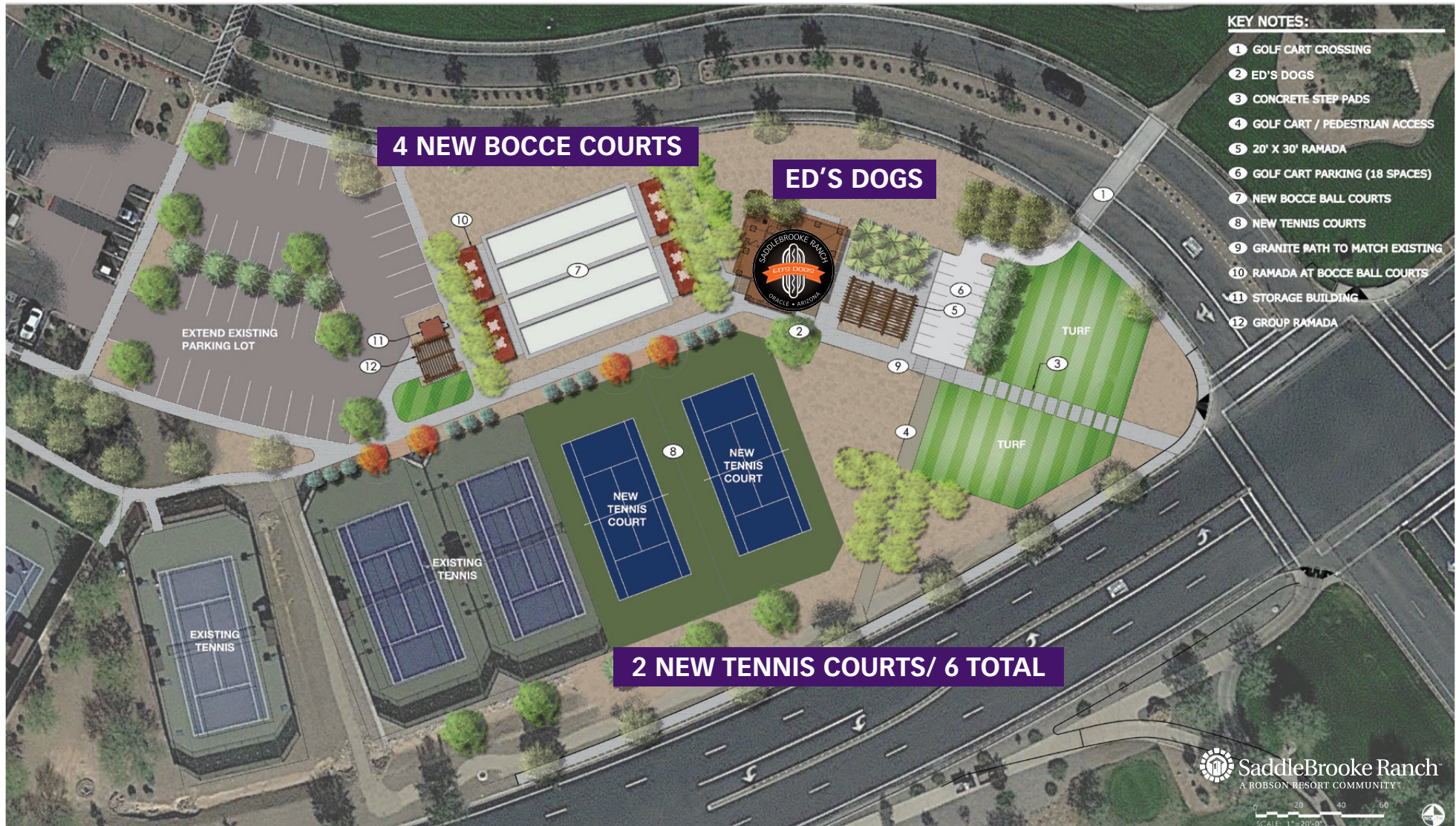

The housing at any Robson Resort Community™ is intended for occupancy by at least one person 55 years of age or older per dwelling unit, although the occupants of a limited number of dwelling units may be younger. One person must be at least 40 years old in each unit. No one in permanent residence under 19 years of age. Homes are offered and sold by SaddleBrooke Development Company, broker for Robson Ranch Mountains, LLC, owner. Robson Ranch Arizona Construction Company, general contractor, ROC 192584. No offer for sale or lease may be made or accepted prior to buyer's receipt of an Arizona subdivision public report. A public report is available on the state real estate department's website. Some amenities not included in community service fees. The golf course, pro shop and practice facility are open to the public and will be owned by the developer or its assignee(s). Availability of these facilities for use by owners of interests in the development is at the pleasure of the owners of the facilities. Bistro Veinte is currently open to the public. All photos/pictorials are artist's conception. Information is subject to change without notice. This shall not constitute an offer in any state where registration is required or if in violation of law. © 2021 Robson Communities®, Inc. All rights reserved. 2/23/21



COMMUNITY GARDEN NOW OPEN

The community garden at SaddleBrooke Ranch features 110 individual 4ft x 8ft boxes, which homeowners can lease on an annual basis. In addition, the Community Garden includes material/storage boxes, a storage shed, and ramada.

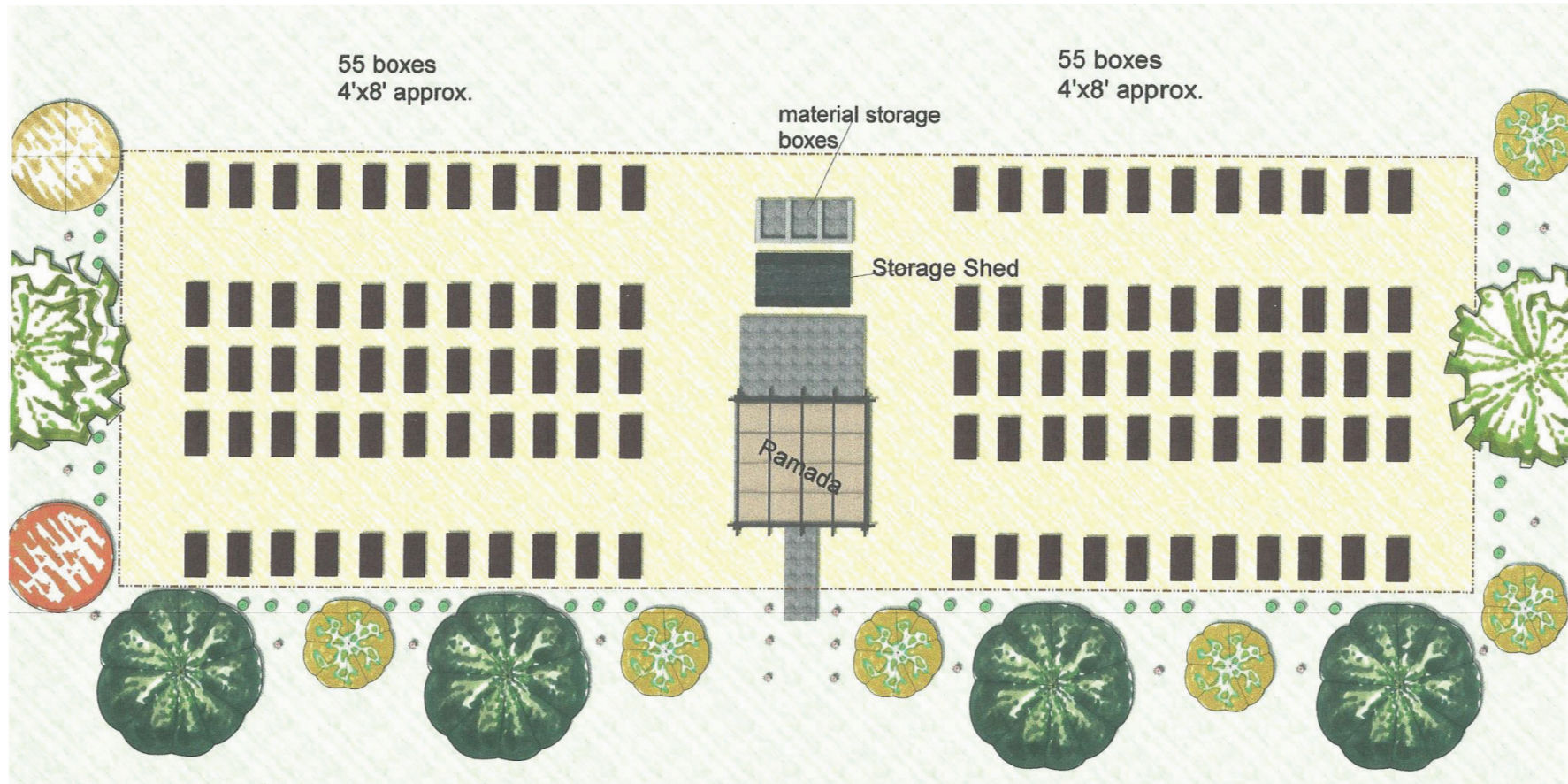

The housing at any Robson Resort Community™ is intended for occupancy by at least one person 55 years of age or older per dwelling unit, although the occupants of a limited number of dwelling units may be younger. One person must be at least 40 years old in each unit. No one in permanent residence under 19 years of age. Homes are offered and sold by SaddleBrooke Development Company, broker for Robson Ranch Mountains, LLC, owner. Robson Ranch Arizona Construction Company, general contractor, ROC 192584. No offer for sale or lease may be made or accepted prior to buyer's receipt of an Arizona subdivision public report. A public report is available on the state real estate department's website. There are additional fees (not included in the HOA fees) for using some of the recreational facilities. The golf course, pro shop and practice facility are open to the public and will be owned by the developer or its assignee(s). Availability of these facilities for use by owners of interests in the development is at the pleasure of the owners of the facilities. The Ranch House and Bistro Veinte currently are open to the public. All photos/pictorials are artist's conception. Information is subject to change without notice. This shall not constitute an offer in any state where registration is required or in violation of law. © 2021 Robson Communities®, Inc. All rights reserved. 2/16/21 20RC021

